

## *48 Units Terraced Housing*

Site Development Works of a Residential Subdivision

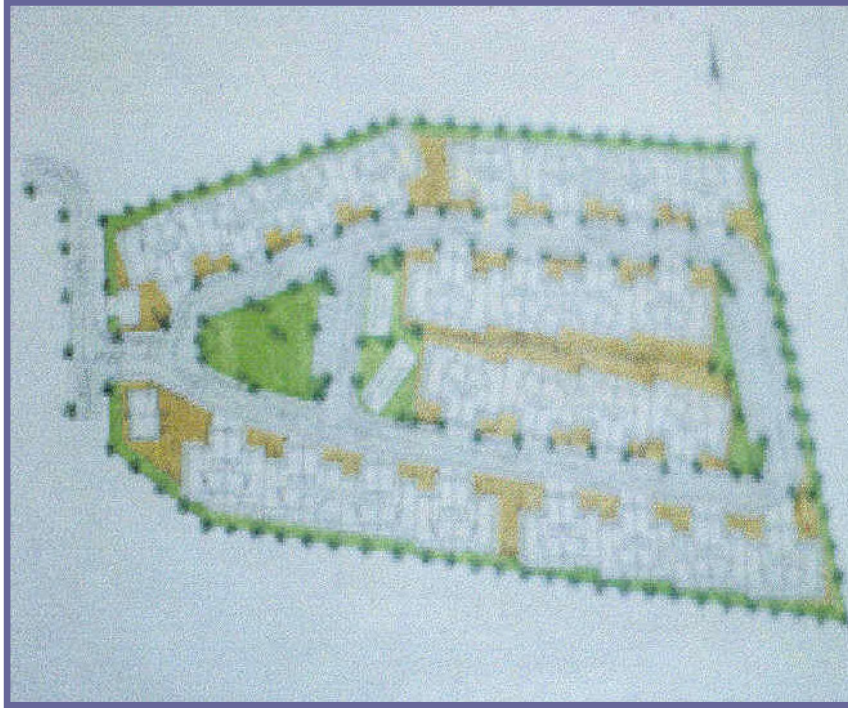

**Client**

Baharuddin & Associates

**Project**

48 Units Terraced Housing

**Location**

Bandari, Seri, Bagawan, Darussalam

**Project Period**

Start October 1993

End December 1993

**Project Description**

The Project rested on a 1.60-hectare residential subdivision located in Brunei. The site is near the Brunei Airport with a wide football field nearby and is surrounded by newly developed lots. The 48 units (formerly 32 units but subsequently increased during its revision) are of the two-storey type and afforded with basketball and tennis court as its amenities for its dwellers.

**Scope of Services**

Trans-Asia provided Detailed Engineering for Site Development, Bridge, Reinforced Concrete Retaining Wall and Slope Protection Works.

